

【参考資料1】事業対象地概要図

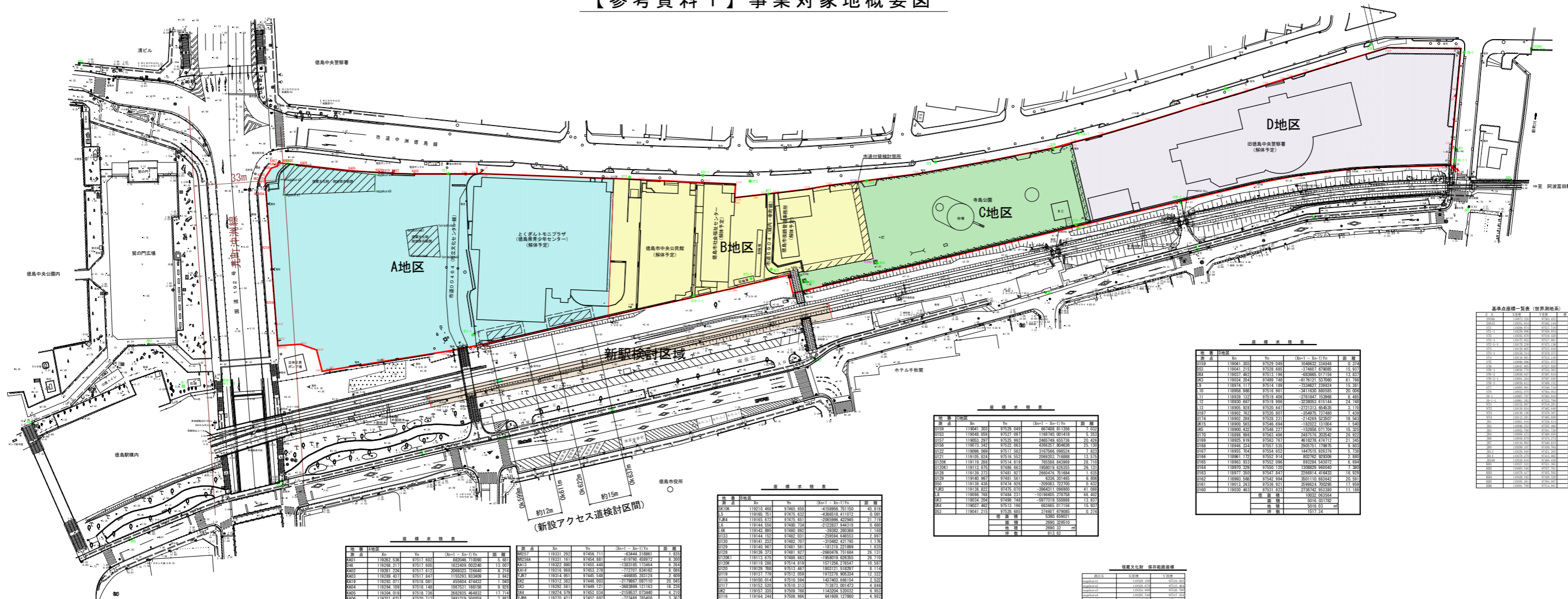
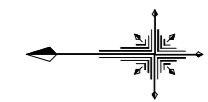

基礎点一覧表 (A地区)

点名	Xn	Yn	(Xn-1 - Xn-1)Yn	面積
RA01	119262.536	97517.602	100000.710000	6.181
RA2	119248.211	97517.602	1022400.002240	1.100
RA3	119281.244	97517.612	2000000.700000	0.716
RA03	119289.431	97517.617	1155292.902000	3.242
RA11	119289.181	97518.181	400000.410000	1.000
RA04	119294.009	97518.181	1009351.100186	6.102
RA05	119304.010	97518.186	2062920.460322	1.714
RA06	119321.024	97519.113	2401719.200000	1.803
RA02C	119329.461	97517.539	922350.715862	1.871
RA07	119331.076	97517.589	100000.310181	1.200
RA08	119331.204	97520.518	234140.769916	2.400
RA09	119333.409	97519.163	420111.710100	3.400
RA10	119335.094	97519.163	72074.910100	0.800
RA11	119335.766	97519.168	-11625.400140	4.400
RA12A	119335.439	97519.474	-185444.921840	18.849
RA12B	119333.003	97497.987	-209700.320000	20.424
RA12C	119332.963	97470.584	-109912.100000	1.161
RA12	119331.812	97483.425	-104383.361176	6.185

基礎点一覧表 (B地区)

点名	Xn	Yn	(Xn-1 - Xn-1)Yn	面積
RB01	119331.211	97484.111	40444.310000	0.100
RB02	119331.161	97484.181	-81790.468872	6.300
RB03	119322.080	97485.440	-120185.112444	6.204
RB04	119316.944	97483.219	-77277.601160	6.084
RB05	119314.951	97482.548	-446885.281726	2.800
RB06	119313.281	97482.003	-217688.081116	20.248
RB07	119292.581	97449.121	-388388.181163	18.238
RB08	119274.579	97452.034	-210923.713440	4.216
RB09	119270.421	97452.034	-224419.364000	4.200
RB10	119267.155	97453.209	-147024.289920	8.878
RB11	119258.451	97454.536	-101108.401432	6.124
RB12	119256.568	97455.359	-695681.62249	47.233
RB13	119251.489	97455.555	-489298.650000	58.240
RB14	119248.431	97515.140	175333.814000	8.848
RB15	119242.268	97516.090	489200.277100	44.378
RB16	119238.611	97517.118	4420912.62746	1.000
RB17	119237.203	97517.729	161180.184200	6.960
RB18	119238.311	97517.611	142634.480700	6.468
RB19	119236.131	97517.608	412011.883800	9.964
RB20	119235.766	97517.608	15671.822900	0.200
RB21	119235.766	97483.424	7648.904844	1.100
RB22	119235.766	97483.424	2214.700	0.000

基礎点一覧表 (C地区)

点名	Xn	Yn	(Xn-1 - Xn-1)Yn	面積
RC01	119041.203	97529.049	607488.811359	7.029
RC02	119000.000	97527.000	1187000.000000	0.200
RC03	119023.297	97525.993	2465449.651250	20.420
RC04	119010.247	97527.043	4394207.804800	26.130
RC05	119000.000	97517.000	3125000.000000	1.824
RC06	119105.824	97516.553	2009203.718880	13.310
RC07	119119.288	97514.818	161684.820000	20.710
RC08	119113.635	97486.663	1080018.626550	26.131
RC09	119110.337	97481.921	2866478.761884	1.630
RC10	119106.967	97481.501	8030.204650	4.806
RC11	119129.439	97474.939	-209831.727200	0.620
RC12	119118.021	97476.016	-306411.999000	41.000
RC13	119086.789	97484.231	-1018605.272820	64.402
RC14	119086.284	97489.744	-597719.900000	14.874
RC15	119077.462	97512.194	60365.371750	15.971
RC16	119041.215	97528.685	374407.879000	0.374
RC17	119041.215	97528.685	3000.000000	0.000
RC18	119041.215	97528.685	2990.329510	0.374
RC19	119041.215	97528.685	3000.000000	0.000
RC20	119041.215	97528.685	3000.000000	0.374
RC21	119041.215	97528.685	3000.000000	0.374
RC22	119041.215	97528.685	3000.000000	0.374
RC23	119041.215	97528.685	3000.000000	0.374
RC24	119041.215	97528.685	3000.000000	0.374
RC25	119041.215	97528.685	3000.000000	0.374
RC26	119041.215	97528.685	3000.000000	0.374
RC27	119041.215	97528.685	3000.000000	0.374
RC28	119041.215	97528.685	3000.000000	0.374
RC29	119041.215	97528.685	3000.000000	0.374
RC30	119041.215	97528.685	3000.000000	0.374
RC31	119041.215	97528.685	3000.000000	0.374
RC32	119041.215	97528.685	3000.000000	0.374
RC33	119041.215	97528.685	3000.000000	0.374
RC34	119041.215	97528.685	3000.000000	0.374
RC35	119041.215	97528.685	3000.000000	0.374
RC36	119041.215	97528.685	3000.000000	0.374
RC37	119041.215	97528.685	3000.000000	0.374
RC38	119041.215	97528.685	3000.000000	0.374
RC39	119041.215	97528.685	3000.000000	0.374
RC40	119041.215	97528.685	3000.000000	0.374
RC41	119041.215	97528.685	3000.000000	0.374
RC42	119041.215	97528.685	3000.000000	0.374
RC43	119041.215	97528.685	3000.000000	0.374
RC44	119041.215	97528.685	3000.000000	0.374
RC45	119041.215	97528.685	3000.000000	0.374
RC46	119041.215	97528.685	3000.000000	0.374
RC47	119041.215	97528.685	3000.000000	0.374
RC48	119041.215	97528.685	3000.000000	0.374
RC49	119041.215	97528.685	3000.000000	0.374
RC50	119041.215	97528.685	3000.000000	0.374
RC51	119041.215	97528.685	3000.000000	0.374
RC52	119041.215	97528.685	3000.000000	0.374
RC53	119041.215	97528.685	3000.000000	0.374
RC54	119041.215	97528.685	3000.000000	0.374
RC55	119041.215	97528.685	3000.000000	0.374
RC56	119041.215	97528.685	3000.000000	0.374
RC57	119041.215	97528.685	3000.000000	0.374
RC58	119041.215	97528.685	3000.000000	0.374
RC59	119041.215	97528.685	3000.000000	0.374
RC60	119041.215	97528.685	3000.000000	0.374
RC61	119041.215	97528.685	3000.000000	0.374
RC62	119041.215	97528.685	3000.000000	0.374
RC63	119041.215	97528.685	3000.000000	0.374
RC64	119041.215	97528.685	3000.000000	0.374
RC65	119041.215	97528.685	3000.000000	0.374
RC66	119041.215	97528.685	3000.000000	0.374
RC67	119041.215	97528.685	3000.000000	0.374
RC68	119041.215	97528.685	3000.000000	0.374
RC69	119041.215	97528.685	3000.000000	0.374
RC70	119041.215	97528.685	3000.000000	0.374
RC71	119041.215	97528.685	3000.000000	0.374
RC72	119041.215	97528.685	3000.000000	0.374
RC73	119041.215	97528.685	3000.000000	0.374
RC74	119041.215	97528.685	3000.000000	0.374
RC75	119041.215	97528.685	3000.000000	0.374
RC76	119041.215	97528.685	3000.000000	0.374
RC77	119041.215	97528.685	3000.000000	0.374
RC78	119041.215	97528.685	3000.000000	0.374
RC79	119041.215	97528.685	3000.000000	0.374
RC80	119041.215	97528.685	3000.000000	0.374
RC81	119041.215	97528.685	3000.000000	0.374
RC82	119041.215	97528.685	3000.000000	0.374
RC83	119041.215	97528.685	3000.000000	0.374
RC84	119041.215	97528.685	3000.000000	0.374
RC85	119041.215	97528.685	3000.000000	0.374
RC86	119041.215	97528.685	3000.000000	0.374
RC87	119041.215	97528.685	3000.000000	0.374
RC88	119041.215	97528.685	3000.000000	0.374
RC89	119041.215	97528.685	3000.000000	0.374
RC90	119041.215	97528.685	3000.000000	0.374
RC91	119041.215	97528.685	3000.000000	0.374
RC92	119041.215	97528.685	3000.000000	0.374
RC93	119041.215	97528.685	3000.000000	0.374
RC94	119041.215	97528.685	3000.000000	0.374
RC95	119041.215	97528.685	3000.000000	0.374
RC96	119041.215	97528.685	3000.000000	0.374
RC97	119041.215	97528.685	3000.000000	0.374
RC98	119041.215	97528.685	3000.000000	0.374
RC99	119041.215	97528.685	3000.000000	0.374
RC100	119041.215	97528.685	3000.000000	0.374

基礎点一覧表 (D地区)

点名	Xn	Yn	(Xn-1 - Xn-1)Yn	面積
RD01	119041.203	97529.049	1046032.344800	0.374
RD02	119041.215	97528.625	-216003.970000	18.231
RD03	119037.482	97513.198	-682668.017164	13.831
RD04	119034.204	97489.748	-317021.527080	61.780
RD05	119014.117	97519.188	-745827.808000	16.284
RD06	118988.988	97518.981	-3411820.888585	20.000
RD07	118959.113	97519.458	-2163847.930000	8.485
RD08	118930.687	97518.988	-3236883.818144	24.741
RD09	118905.402	97520.441	-2221212.464000	2.110
RD10	118897.952	97520.801	-264976.710000	1.251
RD11	118892.288	97528.231	-214249.923007	18.543
RD12	118890.963	97544.184	182922.310804	1.463
RD13	118900.422	97544.221	-153888.871709	18.203
RD14	118898.869	97527.488	483174.900000	61.243
RD15	118926.919	97525.761	6018276.476172	21.243
RD16	118846.314	97521.535	2005251.799705	0.803
RD17	118858.324	97544.635	1443126.820219	5.733
RD18	118861.122	97529.914	802762.829006	2.800
RD19	118863.853	97529.909	88384.400000	0.400
RD20	118870.329	97529.120	1308826.900000	7.380
RD21	118877.260	97547.841	226891.418433	16.824
RD22	118864.680	97545.994	260110.863462	20.981
RD23	118813.243	97528.921	938824.002000	17.800
RD24	118809.483	97527.122	228142.900000	21.100
RD25	118809.483	97527.122	10000.000000	0.000
RD26	118809.483	97527.122	10000.000000	0.000
RD27	118809.483	97527.122	10000.000000	0.000
RD28	118809.483	97527.122	10000.000000	0.000
RD29	118809.483	97527.122	10000.000000	0.000